



# Bourdon Tube Pressure Gauges

## Solid-Front Turret Style Thermoplastic Case

4½" & 6" Process Industry Series

316SS Wetted Parts • Type 23X.34

### Pressure Gauges

#### Application

Industrial type suitable for corrosive environments where the fluid medium does not clog connection or corrode wetted part material. Field convertible to a liquid filled gauge for severe vibration conditions. Solid front, blow-out back case design meets safety requirements of ASME B40.1.

#### Size

4½"(115mm) & 6" (152 mm) dial size

#### Accuracy

± 0.5% of span (ASME B40.1 Grade 2A)

#### Ranges

Vacuum / Compound to 30"HG / 0 / 400 PSI  
Pressure from 15 PSI to 30,000 PSI  
or other equivalent units of pressure or vacuum  
Receiver scale: 3...15psi

#### Working Range

Steady: Full scale value  
Fluctuating: 0.9 x full scale value  
Short time: 1.5 x full scale value

#### Operating Temperature

Ambient: -40°F to 150°F (-40°C to 65.6°C) <sup>Note 1</sup>

Media: 212°F - max.  
\*\*500°F - dry gauge (intermittent) Optional  
\*\*250°F - Liquid filled (intermittent) Optional  
\*\*300°F - Dampened Movement (4½" only)

#### Temperature Error

Additional error when temperature changes from reference temperature of 68°F (20°C), approximately ±1.5% per 100°F (55.5°CΔ T) rising or falling. Percentage of span.

### Standard Features

#### Connection

Material: 316 stainless steel  
Lower mount (LM) + Lower back mount (LBM)  
1/4" NPT and 1/2" NPT have M4 internal tap - STD.

#### Bourdon Tube

Material: 316 stainless steel  
30" Hg (Vac) to 1000 PSI C-type  
1500 PSI to 10,000 PSI helical type

#### Movement

Stainless steel  
Internal stop pin at 1.3 times full scale value  
Overload and underload stops- standard  
Optional: dampened movement

#### Shock & Vibration

Shock resistance up to 100G  
Optional: up to 400G  
Optional: vibration resistance up to 10G

#### Cycle Testing

400,000-2,000,000\*cycles, depending upon pressure range (4½" only)

\*liquid filled

#### Dial

White aluminum with black lettering. Stop pin at 6 o'clock



#### Pointer

Adjustable black al

#### Case

Black glass reinforced thermoplastic (PBTP)  
Solid front, blow-out back  
Turret style case with built in rear flange lugs

#### Weather Protection

Weather resistant (NEMA 3 / IP 54) - dry case  
Weather tight (NEMA 4X / IP 65) - liquid-filled case

#### Standard Scale

PSI  
Receiver scales 0/100% linear, 0/10 sq. rt.

#### Window Gasket

Buna-N

#### Window

Acrylic

#### Case Filling

None - 232.34  
Glycerine - 233.34  
Dampened movement - 239.34

#### Order Options (min. order may apply)

Overpressure protection up to 5x scale (limited ranges only)  
Threaded restrictor  
Silicone dampened movement  
Panel mounting adaptor kit (field assembled) (4½" only)  
Movement with PTFE coated gears  
Glycerine, silicone, or fluorolube case filling <sup>Note 1</sup>  
Field conversion kit for glycerine, silicone, or fluorolube fill  
Cleaned for oxygen service  
Glass window  
Safety glass window  
Externally adjustable red drag pointer (max. hand) (4½" only)  
Externally adjustable red mark pointer (4½" only)  
Special connections limited to socket square size  
DIN standards  
Custom dial layout  
Other pressure scales available:  
Bar, kPa, MPa, Kg/cm<sup>2</sup>, and dual scales  
Alarm contact switches (4½" only)  
Shock resistant up to 400G  
Vibration resistant up to 10G  
Luminescent dial (4½" only)  
Alloy steel socket connection (4½" only)  
Chemical seals available

Note 1 Temperature Ranges (Liquid filled gauges)  
Glycerine: -4°F to 150°F (-20°C to 65.6°C)  
Silicone: -40°F to 150°F (-40°C to 65.6°C)

**APM 23X.34**  
**(Apm 02.10)**

**Dimensions:**

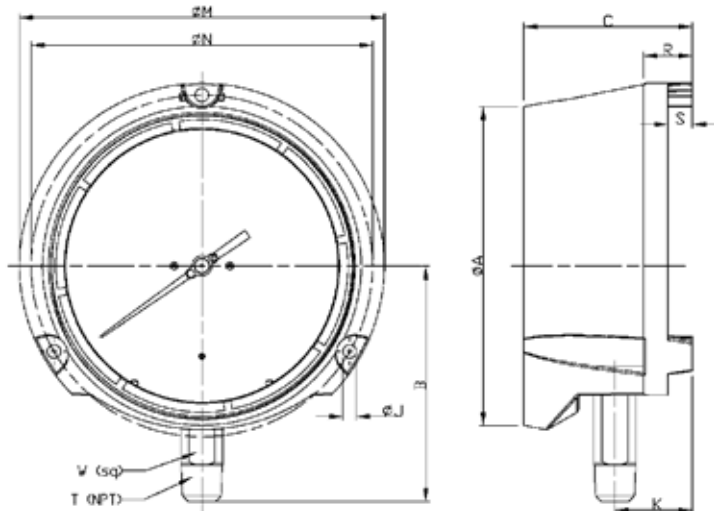

TYPE	SIZE	WEIGHT	KEY	A	B	C	J	K	M	N	R	S	T	W	
2XX.34 LM	4.5"	2lbs.* (dry)	mm	128	103	84	6.3	40	148	136.5	25	12.5	--	22	* liquid filled 3lbs.
			inch	5	4.06	3.31	0.248	1.57	5.83	5.37	0.99	0.49	1/2"	0.87	
	6"	3lbs.* (dry)	mm	164	122.5	88	7.1	40.2	190	177.8	25.4	12.7	--	22	* liquid filled 4lbs.
			inch	6.46	4.82	3.46	0.28	1.58	7.5	7	1	0.5	1/2"	0.87	

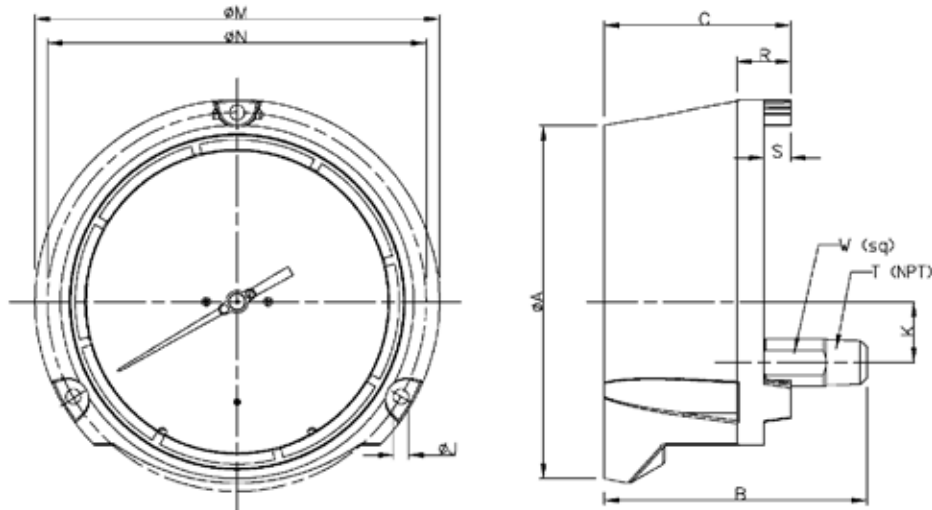

TYPE	SIZE	WEIGHT	KEY	A	B	C	J	K	M	N	R	S	T	W	
2XX.34 LBM	4.5"	2lbs.* (dry)	mm	128	120.3	84	6.3	28.5	148	136.5	25.1	12.5	--	22	* liquid filled 3lbs.
			inch	5	4.736	3.31	0.248	1.122	5.83	5.37	0.99	0.49	1/2"	0.87	
	6"	3lbs.* (dry)	mm	164	0.191	88	7.1	28.5	190	177.8	25.4	12.7	--	22	* liquid filled 4lbs.
			inch	6.46	4.86	3.46	0.28	1.122	7.5	7	1	0.5	1/2"	0.87	

\*\*Technical Note: Maximum continuous media temperatures of 212°F is recommended. Maximum temperatures shown are for intermittent, short term exposure. User should consider temperature error and gauge component degradation when exposing gauge to any media or ambient temperature above 140 °F. For continuous use in either ambient or media temperatures above 140 °F, a diaphragm seal or other heat-dissipating means is recommended. Consult factory for technical inquiries and application assistance.

**Ordering Information:**

State computer part number (if available) / type number / size / range / connection size and location / options required.

Specifications given in this price list represent the state of engineering at the time of printing. Modifications may take place and the specified materials may change without prior notice.

  
[www.wika.ws](http://www.wika.ws)

 (800) 576-6308